

---

## Lesson 2 Bluetooth Car

---

### *Points of this section*

*It is very important and so cool to control your car wirelessly in a certain space when we learn the Arduino, so in the lesson, we will teach you how to control a car by Bluetooth.*

#### *Learning Parts:*

- ◆ *Learn how to use the Bluetooth module and the Bluetooth APP*
- ◆ *Learn how to control the vehicle via Bluetooth*
- ◆ *Write programs to implement this function*

#### *Preparations:*

- ◆ *A vehicle (equipped with battery)*
- ◆ *A USB cable*
- ◆ *A Bluetooth module*
- ◆ *An iPhone or tablet*

## I . Bluetooth module

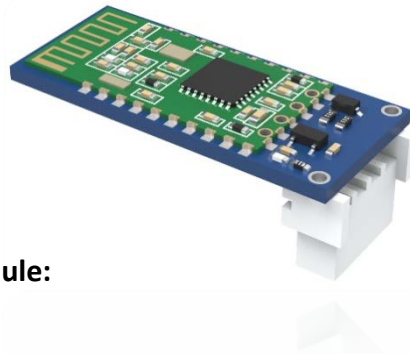

### The description of Bluetooth module:

1. Adopt mainstream Bluetooth chip of TI, protocol standard of Bluetooth V4.0.
2. Analog working voltage of serial port is 3.3V.
3. Users can set baud rate 1200, 2400, 4800, 9600, 19200, 38400, 57600,115200.
4. Dimension of key module is 28mm x 15 mm x 2.35mm.
5. Working electric current: 40MA.
6. Dormancy electric current: less than 1MA.
7. Being used for GPS navigation system, hydroelectric gas reading system, industrial field mining control system.
8. Can be connected to Bluetooth laptop, computer with Bluetooth adapter, PDA, etc.

### This is the schematic diagram of Bluetooth module connected to UNO controller board:

In the experiment we will connect it to UNO board via expansion board V5.

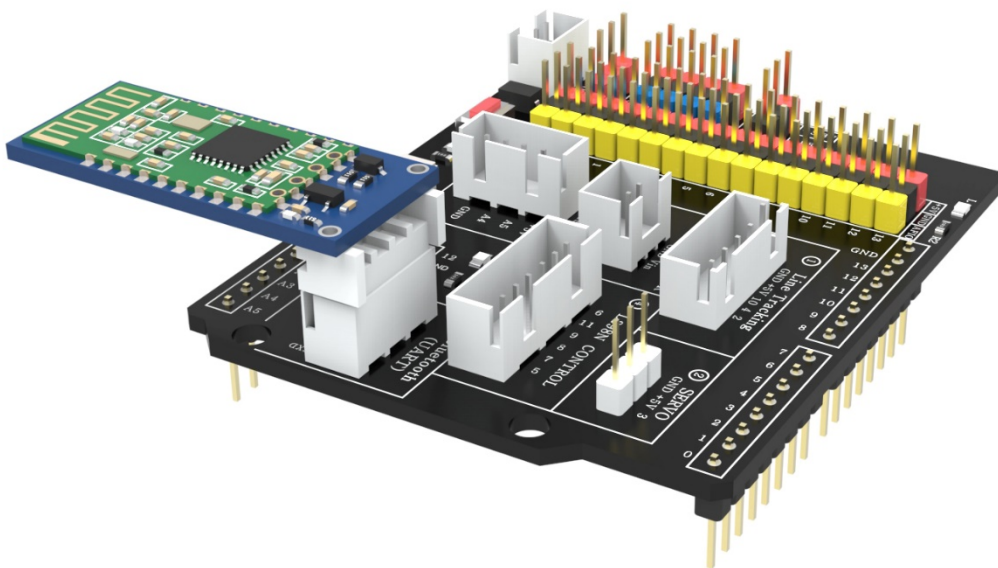

## II. Getting Started with the Bluetooth APP

Before beginning, connect the HC-08 Bluetooth module to the expansion board and turn on the power.

### STEP1: Install the application.

#### For Android

There are two ways to install the application.

1. Copy the “EIEGOO BLE Tool.apk” file to the Android products and install it.

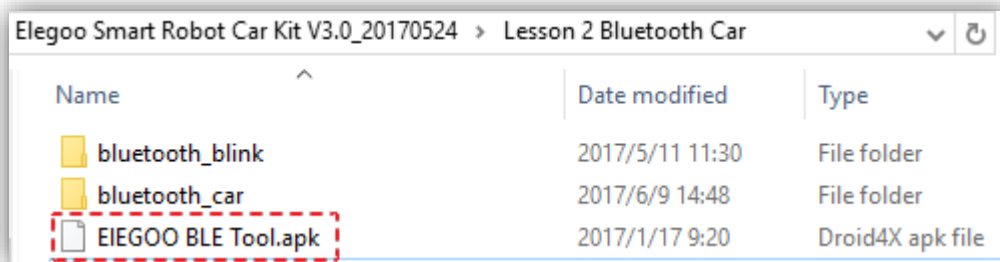

2. Search “EIEGOO BLE Bluetooth Tool” in Google Play Store and install it.

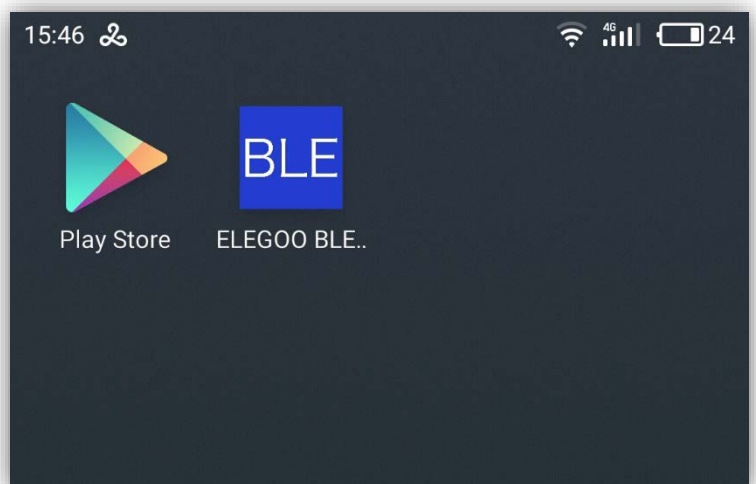
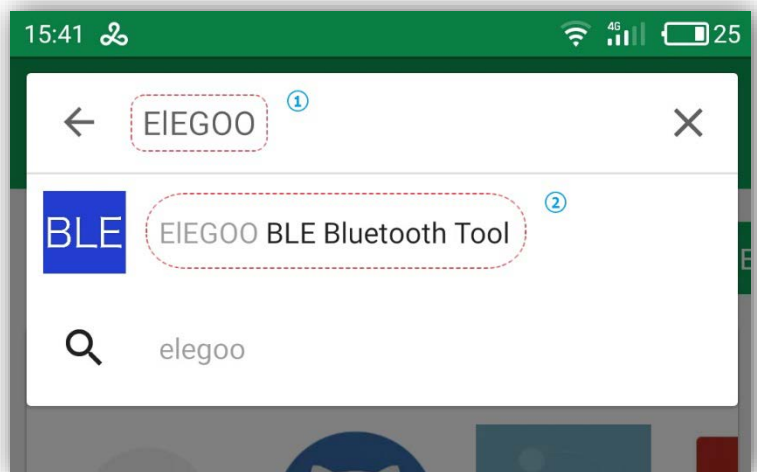
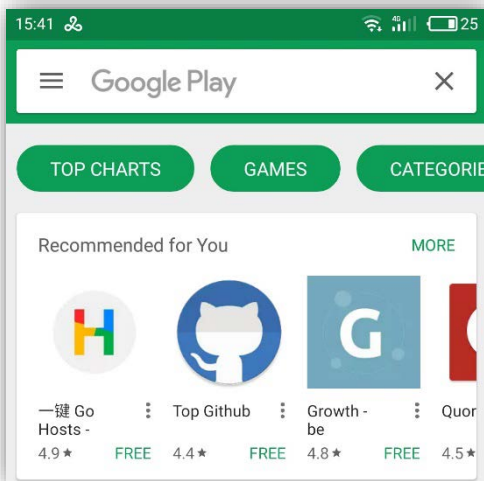

### For iOS

Search “ELEGOO BLE Tool” in Apple APP Store and install it.

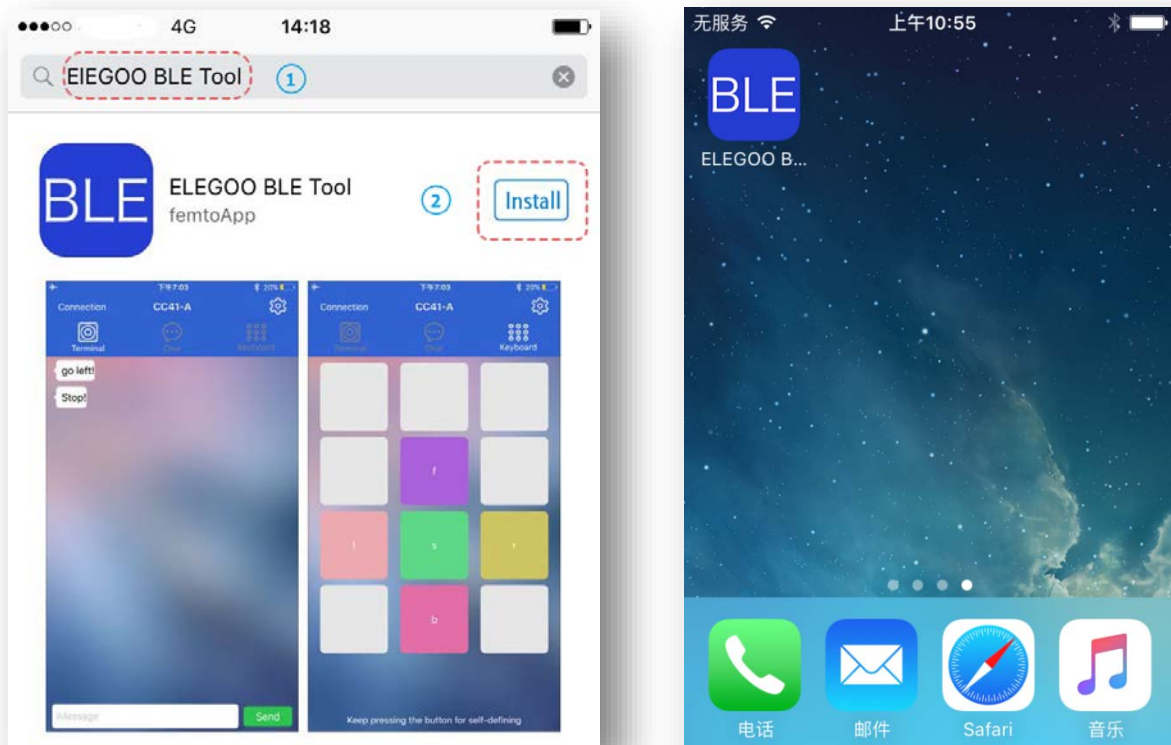

### STEP2: Application Settings.

Launching the application.



If you don't open your Bluetooth, it will show as blow and advise you to turn on Bluetooth function. For Android, click "Allow" that will open the bluetooth automatically. For iOS, click "Settings" that will jump to bluetooth setup interface, you should turn on the bluetooth and then return to the "ELEGOO BLE Tool" APP interface.

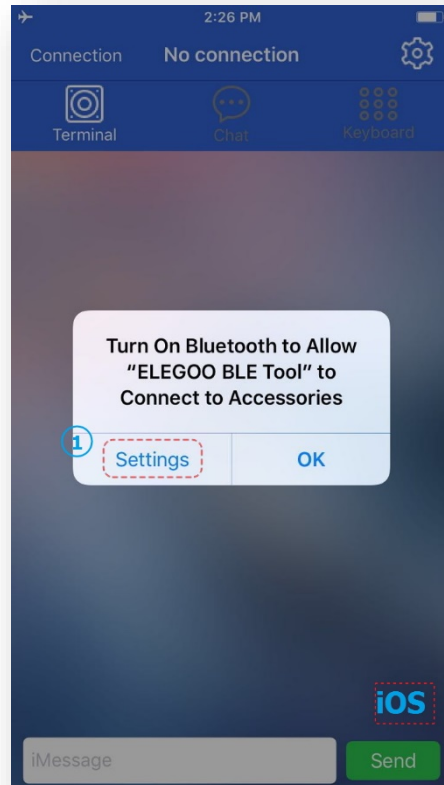
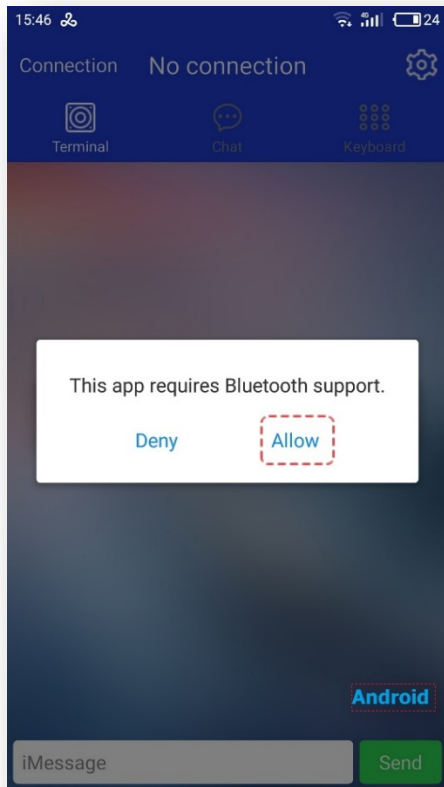

After turn on Bluetooth, the bluetooth icon appears on the APP interface. Click "Connection".



Scan the Bluetooth signal.

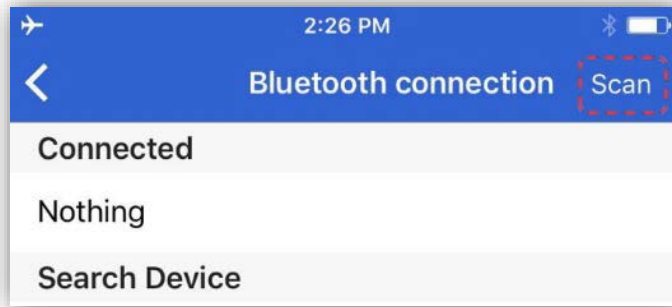

Then you phone will search Bluetooth equipment nearby. HC-08 device appear.

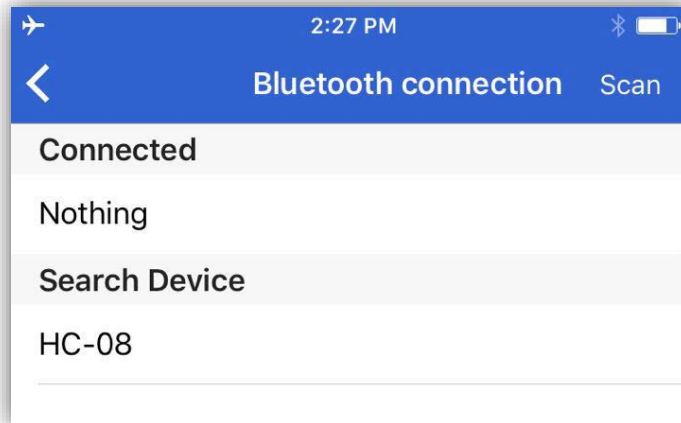

Click the Bluetooth name "HC-08", when the connection is successful, the screen will be displayed "Device Connected".

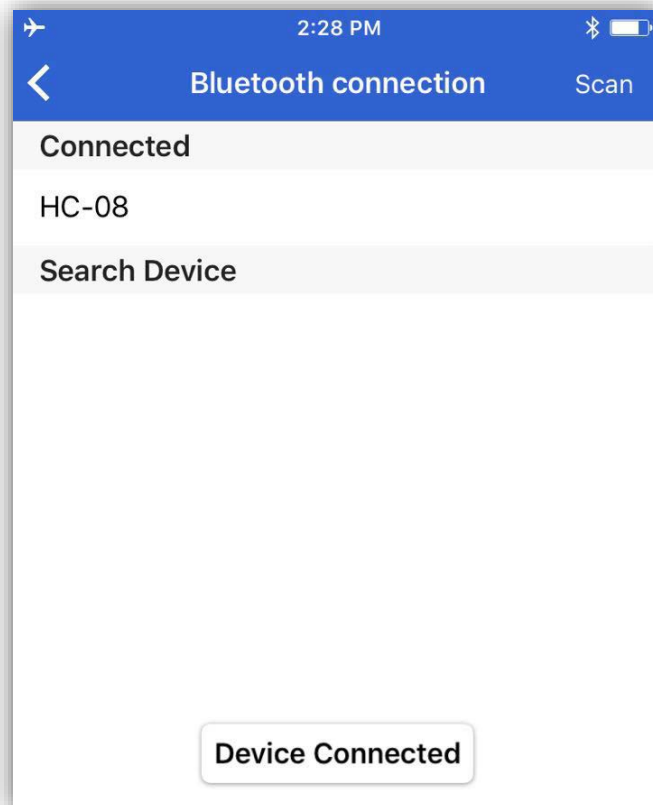

Returns the main interface of the application. After the Bluetooth connection, the Bluetooth name will be displayed on the screen.

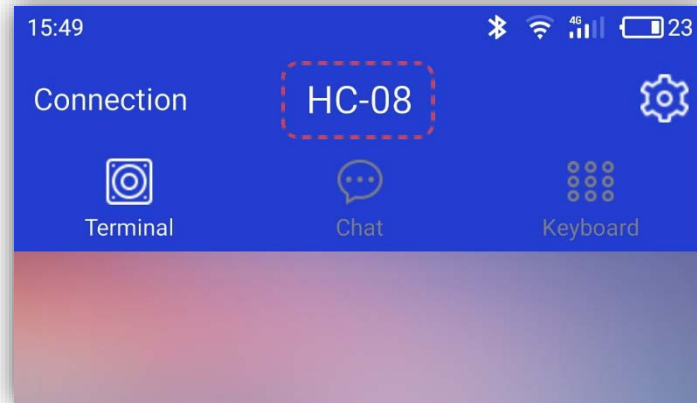

Then we can slide the screen to the right side by our finger and we can get the key pattern as below:

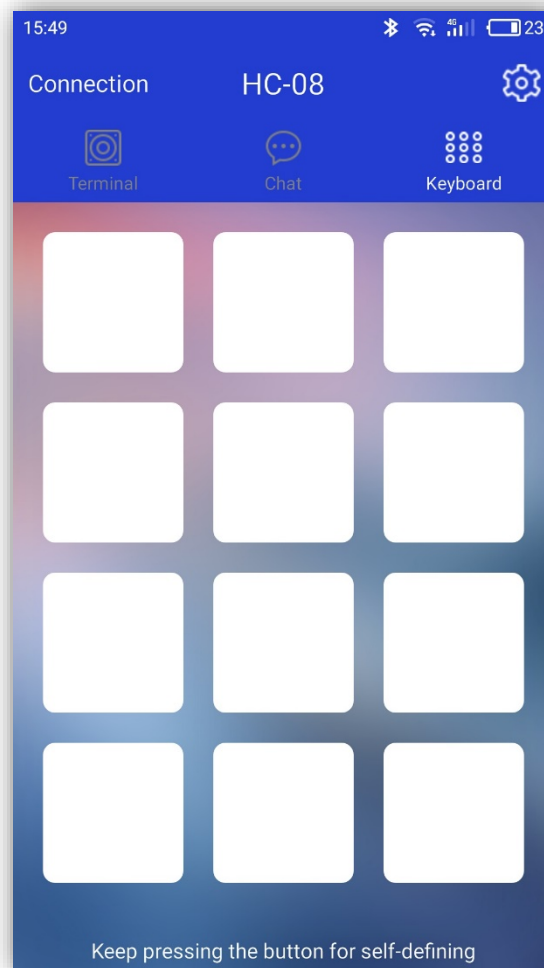

Finally, we set the definition of each button, we will take "go forward" for example, please see below, and the rest key-values are set in the same manner.



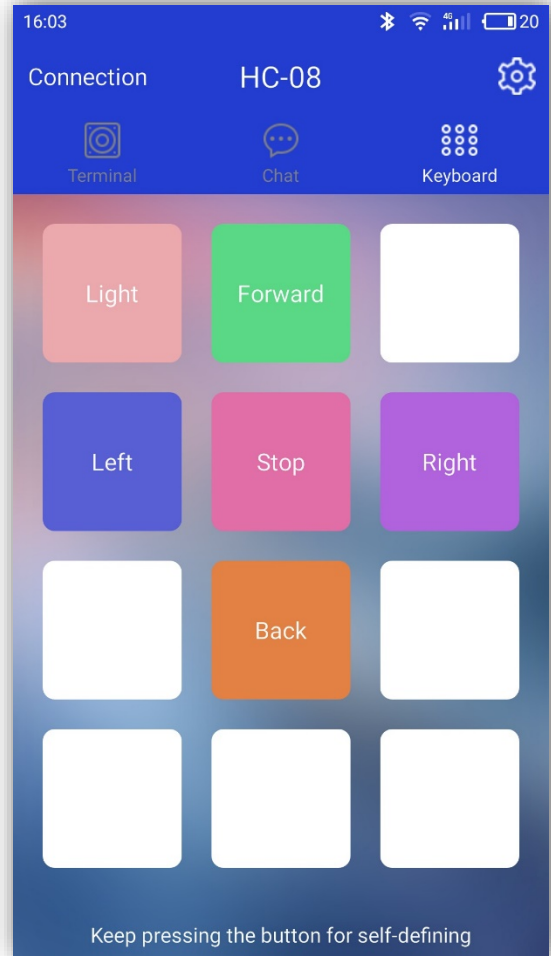
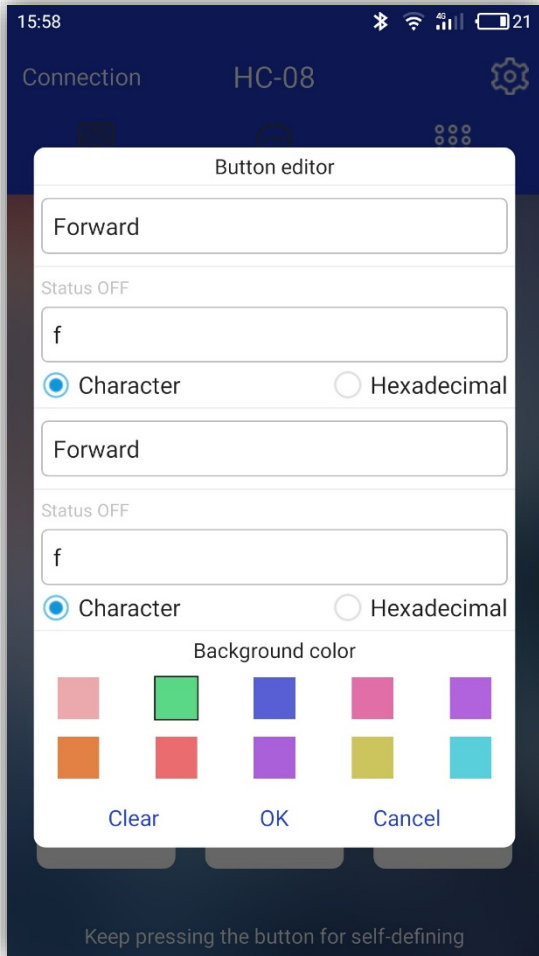



### III. Testing

Open the code file in the path “\Elegoo Smart Robot Car Kit V3.0\bluetooth\_blink\bluetooth\_blink.ino” and upload the program to the UNO board.

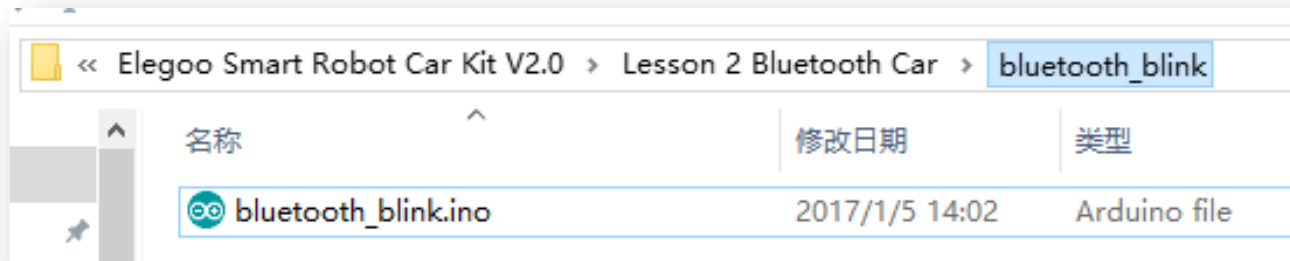

#### Code preview:

```
//www.elegoo.com

#define LED 13 //Define 13 pin for LED
bool state = LOW; //The initial state of the function is defined as a low level
char getstr; //Defines a function that receives the Bluetooth character

void setup() {
  pinMode(LED, OUTPUT);
  Serial.begin(9600);
}

//Control LED sub function
void stateChange() {
  state = !state;
  digitalWrite(LED, state);
}

void loop() {
  //The Bluetooth serial port to receive the data in the function
  getstr = Serial.read();
  if(getstr == 'a'){
    stateChange();
  }
}
```

Disconnect it from the computer, and then switch on the car’s power supply. (TIPS: The Bluetooth module should be pulled out when you upload the program, or it will be failed to upload the program.)

#### Open APP

After connecting the phone to the car through Bluetooth, we set data as below:

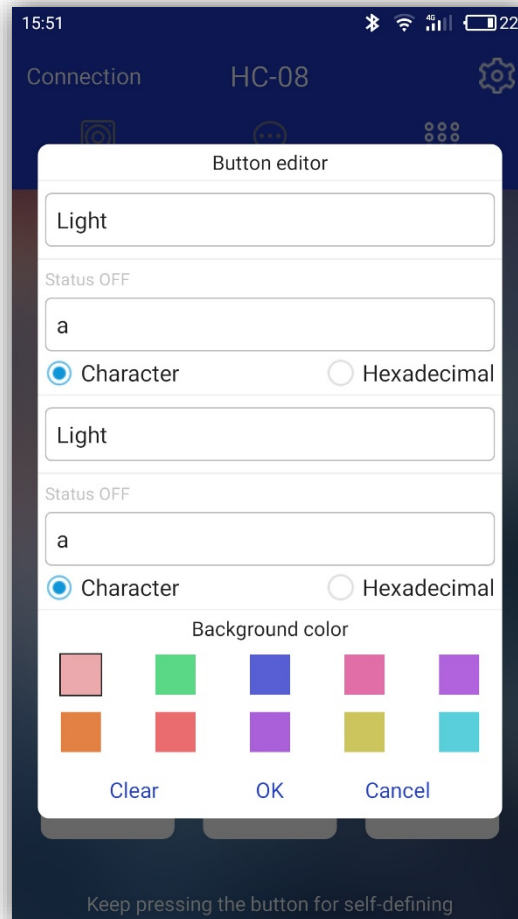

After set-up, press this button. You will find that light on the UNO board changes with the switch.

### The code

```
Serial.begin(9600);
```

The purpose of this block of code is to set the baud rate of the UNO control board as 9600 and open the serial port. In this way, they can communicate with each other, because the original baud rate of the Bluetooth module is 9600.

```
getstr = Serial.read(); //The Bluetooth serial port to receive the data in the function
if(getstr == 'a'){
    stateChange();
}
```

This function is executed repeatedly within the circulating function. It will first read data from the serial port and then check the data. If it meets the condition, it will execute the corresponding sub-function. For example, if it reads the letter 'a' from the serial port, it will execute the sub-function responsible for switching on/off the LED light.

## IV. Make a Bluetooth Car

When the car turns left or right, it's not necessary to set the speed too fast. On the contrary, we need to control the speed of car. But how to control?

The answer is PWM.

PWM is the abbreviation of "Pulse Width Modulation", is called pulse modulation in short, is an effective technology to control analog circuit with digital output of microprocessor, car is used to change speed of motor by altering duty cycle of a square wave. In other words, connect and break circuit between two sides of motor constantly, is switch of holding motor work, motor will not be off when power is off because of the fast speed. So we can control speed of car if we control specific value of power on time and power off time. The speed of car will be max when circuit is holding still. The speed of car will be minimum if circuit is holding off. The speed of car will be median in half time. PWM is a technology to get analog quantity through digital method. A square wave is formed by digital control, square wave signal only have two state of on and off (That is high-low of digital pins). Simulate voltage changing from 0 to 5V by controlling specific value of duration on and off time. Occupied time of on (That is high level in academy) is called pulse width, so PWM is also called pulse width modulation. Let's learn about PWM through five square waves below.

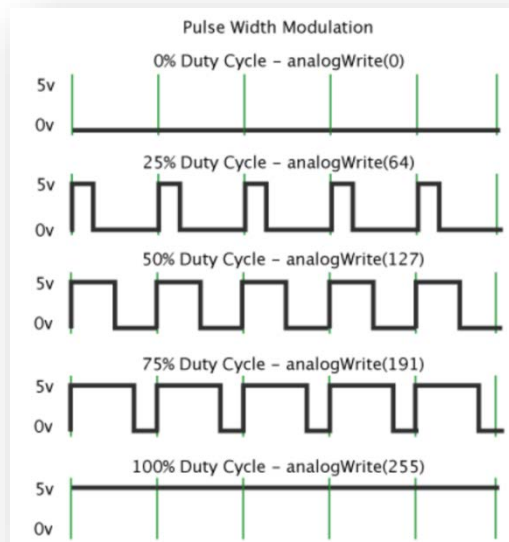

Green vertical line above represent a period of square wave. The value written into every `analogWrite(pin,value)` corresponds to the percentage, the percentage is also called Duty Cycle, refer to the percentage gotten from specific value between duration high level and low level time in a period. In figure, from top to bottom, the first square wave, duty cycle is 0%, corresponding value is 0. Output circuit current is minimum, motor hold still. The longer duration time is, the bigger circuit current motor

gets, the faster the speed is. So, the final one's duty cycle is 100%, corresponding value is 255, motor rotates in full speed. 50% is medium hyponastic rotate speed, 25% is relatively slower, even can't start (The circuit current is relatively big to start motor because of static friction). PWM is mostly used to adjust light of LED and rotate speed of motor, wheel speed controlled by motor is easily be controlled. The advantage of PWM can be more reflected when you play with some Arduino cars.

```
analogWrite(pin, value);
```

analogWrite() is used to write analog value of 0 to 255 for PWM ports. What you need to note is that, analogWrite() is only used to digital pins with function of PWM. Pins with function of PWM in UNO are only digital pins of 3, 5, 6, 9, 10, 11.

Our car's speed is controlled by connecting pin5 and pin6 of ENA and ENB. The program below, have set a digital function `int carSpeed = 150;`

The speed is controlled in below program, so you can control the speed on your own.

```
analogWrite(ENA, carSpeed);  
analogWrite(ENB, carSpeed);
```

After learning the basic knowledge, we will upload the program as below to the car, open the code file in the path “\Elegoo Smart Robot Car Kit V3.0\bluetooth\_car\ bluetooth\_car.ino” and then upload the program to the UNO control board.

### Code preview:

```
//www.elegoo.com  
  
#define ENA 5  
#define ENB 6  
#define IN1 7  
#define IN2 8  
#define IN3 9  
#define IN4 11  
#define LED 13  
  
unsigned char carSpeed = 150;  
bool state = LOW;
```

```
char getstr;

void forward(){
  digitalWrite(ENA,HIGH);
  digitalWrite(ENB,HIGH);
  digitalWrite(IN1,HIGH);
  digitalWrite(IN2,LOW);
  digitalWrite(IN3,LOW);
  digitalWrite(IN4,HIGH);
  Serial.println("Forward");
}

void back(){
  digitalWrite(ENA,HIGH);
  digitalWrite(ENB,HIGH);
  digitalWrite(IN1,LOW);
  digitalWrite(IN2,HIGH);
  digitalWrite(IN3,HIGH);
  digitalWrite(IN4,LOW);
  Serial.println("Back");
}

void left(){
  analogWrite(ENA,carSpeed);
  analogWrite(ENB,carSpeed);
  digitalWrite(IN1,LOW);
  digitalWrite(IN2,HIGH);
  digitalWrite(IN3,LOW);
  digitalWrite(IN4,HIGH);
  Serial.println("Left");
}

void right(){
  analogWrite(ENA,carSpeed);
  analogWrite(ENB,carSpeed);
  digitalWrite(IN1,HIGH);
  digitalWrite(IN2,LOW);
  digitalWrite(IN3,HIGH);
  digitalWrite(IN4,LOW);
  Serial.println("Right");
}

void stop(){
  digitalWrite(ENA,LOW);
```

```
digitalWrite(ENB,LOW);
Serial.println("Stop!");
}

void stateChange(){
  state = !state;
  digitalWrite(LED, state);
}

void setup() {
  Serial.begin(9600);
  pinMode(LED, OUTPUT);
  pinMode(IN1,OUTPUT);
  pinMode(IN2,OUTPUT);
  pinMode(IN3,OUTPUT);
  pinMode(IN4,OUTPUT);
  pinMode(ENA,OUTPUT);
  pinMode(ENB,OUTPUT);
  stop();
}

void loop() {
  getstr = Serial.read();
  switch(getstr){
    case 'f': forward(); break;
    case 'b': back(); break;
    case 'l': left(); break;
    case 'r': right(); break;
    case 's': stop(); break;
    case 'a': stateChange(); break;
    default: break;
  }
}
```

Switch on the power supply of the vehicle and put it on the ground.

Open the mobile APP, and set up parameters as follows.

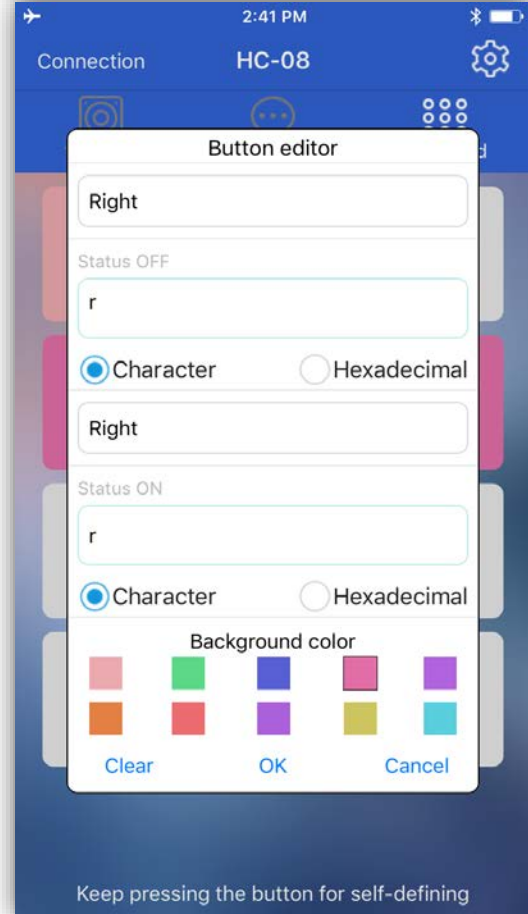
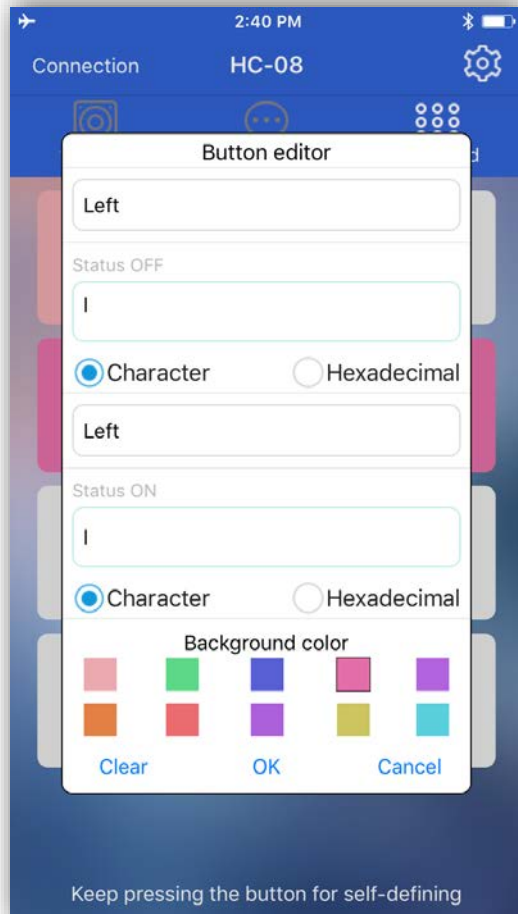
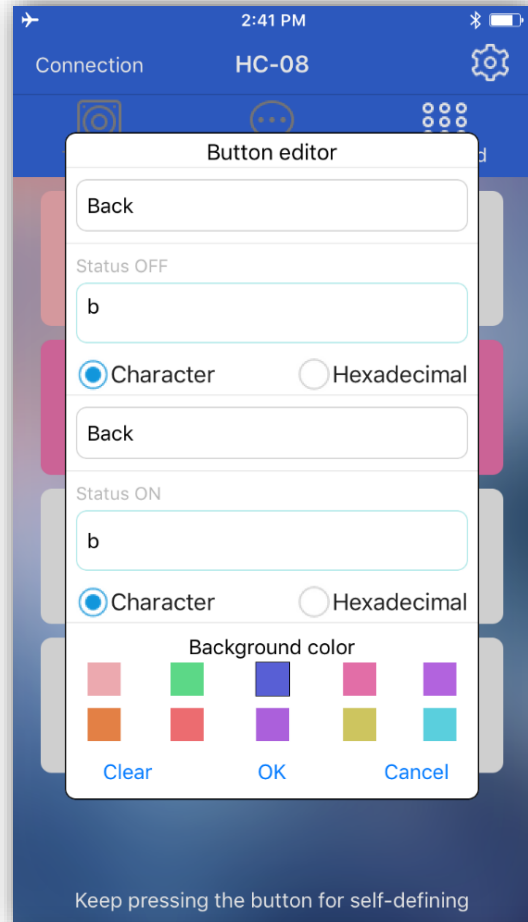
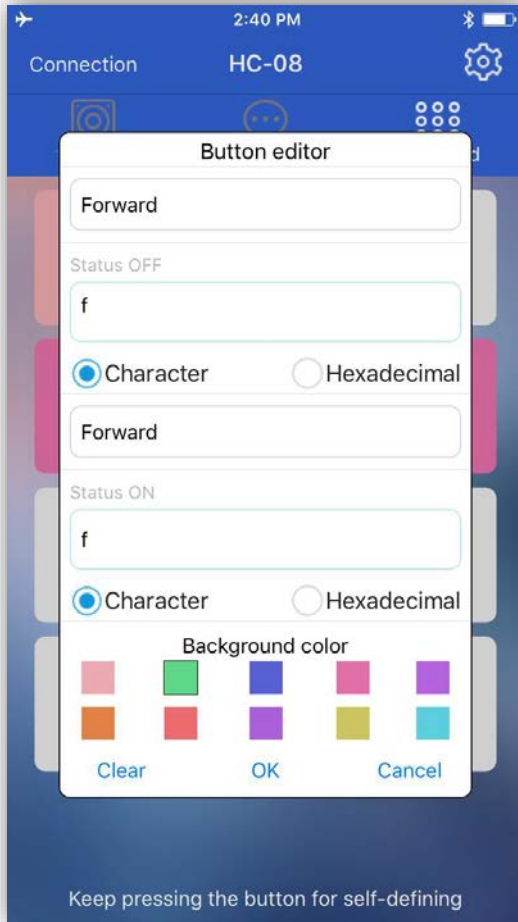



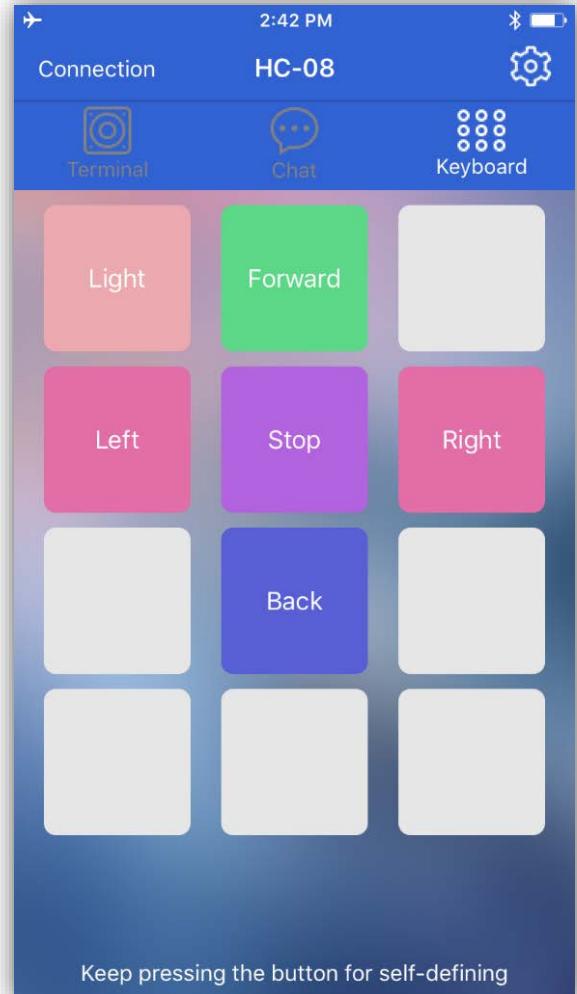
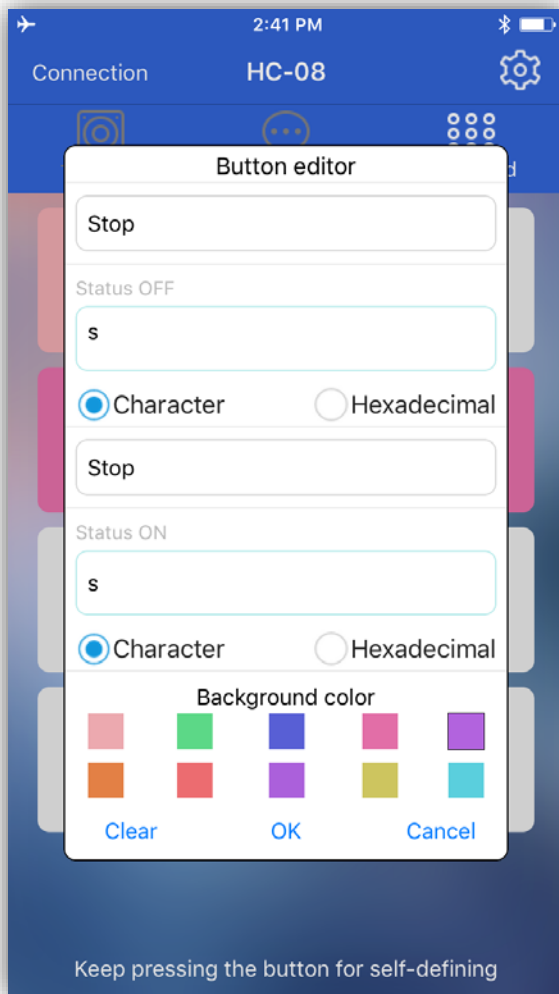

Now we can control the car by Bluetooth and play with it.